



FIRE SUPPRESSION

Fire suppression for all levels
of racing and motorsport



Photograph for illustration purposes

Installation Manual

Model Number: **F-TEC3500MK**

Part Number: **100.000.065.S**

3.5ltr foam system with steel cylinder
and mechanical activation

Model Number: **F-TEC4000MK**

Part Number: **100.000.073.S**

4.0ltr foam system with steel cylinder
and mechanical activation

Important Information

This is a foam based, FIA homologated fire suppression system. To maintain optimum performance all systems should be serviced every two years by the manufacturer or an FEV approved service agent, see website for details.

Please read the following before commencing any installation.

1. This manual should be read and understood before starting installation.
 2. The components supplied should be used in accordance with the installation and any advice FEV provide. If you do not comply with the instructions or any such advice, without limitation, any warranty may be invalidated.
 3. This product should be returned every 2 years from date of last service to FEV or an approved service agent, for a complete check and service – and re-certification for a further 2 years.
 4. Do not connect pull cables to the extinguisher until you have completed the entire installation.
 5. Check cables for free movement before final connections are made.
-

Please Note

FEV FIA approved foam based systems are tested and rated for a temperature operation range of –10 to +60 degrees C in accordance with FIA regulations and Technical List 16. Users should ensure that where high temperatures are anticipated adequate provision is made to locate the system away from high temperature sources (exhaust, catalyst, etc) and if necessary fit reflective insulation around the cylinder.

THIS IS A SAFETY ITEM! CHECK YOUR INSTALLATION CAREFULLY! IF IN DOUBT ASK!

BEFORE EVERY EVENT CHECK SYSTEM CONTENTS, NOZZLES ARE CLEAN AND ALL CONNECTIONS ARE SECURE

FIA

It must be emphasised that any plumbed in fire extinguisher system is mainly designed to delay the development of the fire and consequently give the driver and co-driver time to exit the car; the system is not designed to put out the fire and prevent the car from burning.

Please do not tamper with, make changes or use non FEV parts on your new fire extinguisher system as this will invalidate the homologation and affect the performance of the product. If any new parts are needed, please call FEV on 0044 (0) 1243 55 55 66

If any changes have been made to this product from the original specification, it could in effect stop you racing.

Kit Contents

Qty	Description	Part Number	Drawing Item Number
1	3.5ltr Mechanical Cylinder - Filled & Pressurised (F-TEC3500MK) 4.0ltr Mechanical Cylinder - Filled & Pressurised (F-TEC4000MK)	100.000.064.S 100.000.072.S	1
2	Cradle Bracket (F-TEC3500MK) Cradle Bracket (F-TEC4000MK)	100.300.016 100.300.018	
2	Strap (F-TEC3500MK) Strap (F-TEC4000MK)	100.500.014 100.500.016	
1	6ft Pull Cable	100.800.001	2
1	12ft Pull Cable	100.800.002	3
4.7mtr	10mm Aluminium Tubing	100.800.014	4
4.3mtr	8mm Aluminium Tubing	100.800.013	8
2	Small Foam Cockpit Nozzle in Red Aluminium (with Elbow Connector)	100.800.028	7
4	Small Foam Engine Nozzle in Red Aluminium (with Swivel T Connector)	100.800.026	10+11
1	10mm Metal T Connector	100.900.038	6
1	10mm to 8mm Swivel T Connector	100.900.041	9
1	10mm Metal Y Connector	100.900.035	5
1	Pull Cable Nipple x2	100.800.003	
8	Aluminium Tube Clips 8mm	100.800.011	
8	Aluminium Tube Clips 10mm	100.800.011B	
1	Large 'E' Label	200.300.005	
1	Small 'E' Label	200.300.005B	
1	Instructions		

Installation Instructions

Cradle & Cylinder

Find a suitable position to bolt the fire suppression system cradle to the vehicle structure **SECURELY**. We recommend M6 bolts with shake proof washers and nyloc nuts to bolt the assembly to the floor.

Please note the system must be installed in accordance with championship technical regulations.

Plumbing

Piping & Connectors

Important: Please note the 8mm and 10mm piping supplied fits into various fittings in accordance with the plumbing schematics found in these instructions. Ensure that all 10mm piping pushes into 10mm connectors by 20mm and that 8mm piping pushes into 8mm connectors by 18mm and that all piping is secured. Note that the supply from the firing head should enter the centre branch of the Y connector and exit the two outlets of the Y connector into the two centre branches of the two T connectors. The two outlets of each T connector then supply four engine nozzles and two cockpit nozzles.

Cockpit Nozzle

2 x Small foam nozzles with 10mm x ¼ metal swivel elbows should be positioned and secured with 1 nozzle on each side of the dashboard pointing downwards into the floor pan and towards the occupants' foot area, mounted through pre-formed brackets with a 17mm hole. See nozzle positioning diagrams.

Engine Nozzles

4 x Small foam nozzles with 8mm x ¼ metal swivel T connectors should be positioned and secured in the four corners of the engine bay pointing towards the engine, mounted through pre-formed brackets with a 17mm hole. See schematics for nozzle and plumbing layout.

Pull Cable Installation

Always fit pull cables with the safety pin installed.

Mount the 6ft pull cable through a 10mm hole to enable operation **in accordance with current regulations**, inside the vehicle within easy reach of the driver and co-driver where applicable. Apply the small E label adjacent to the internal pull cable. Mount the 12ft pull cable on an outside panel through a 10mm hole adjacent to the cut out switch and then apply the large E label adjacent to the external pull cable.

Handle Connection

Take the end of the pull cable with the braided wire coming out and push it in to the designated hole found on the underneath of the cable adjuster.

Pull the braided wire part of the cable up through the cable adjuster and through the designated hole found on the top lever of the handle.

Take a cable nipple, un-screw the bolt enough to allow the braided wire to pass through the hole, slide the cable nipple over the braided wire and push it down to the top of the lever, whilst still keeping the tension tighten the bolt back up so that it is clamping down on the braided wire.

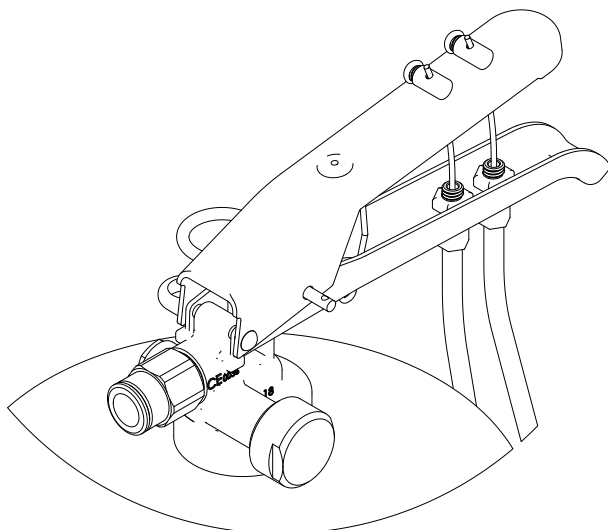

Cockpit Nozzle Positioning Diagrams

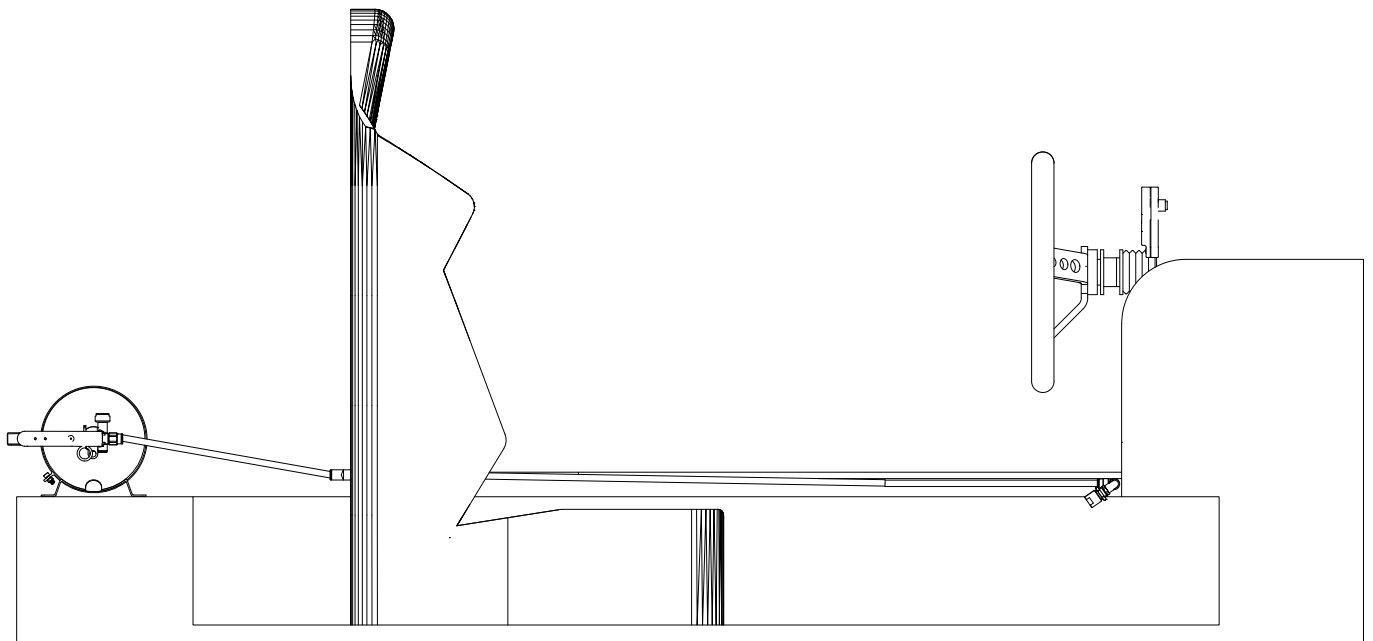
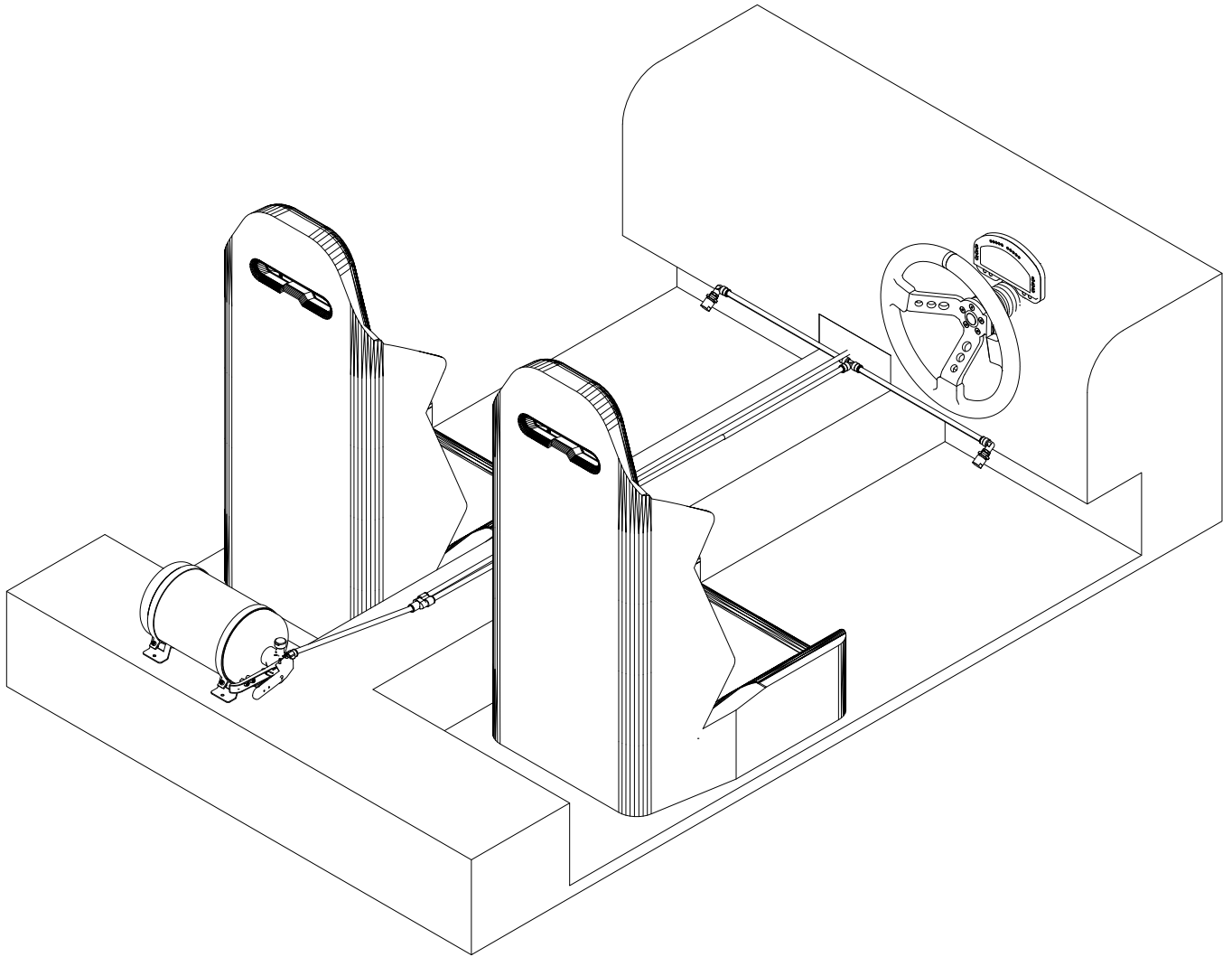

Plumbing Layout Schematics

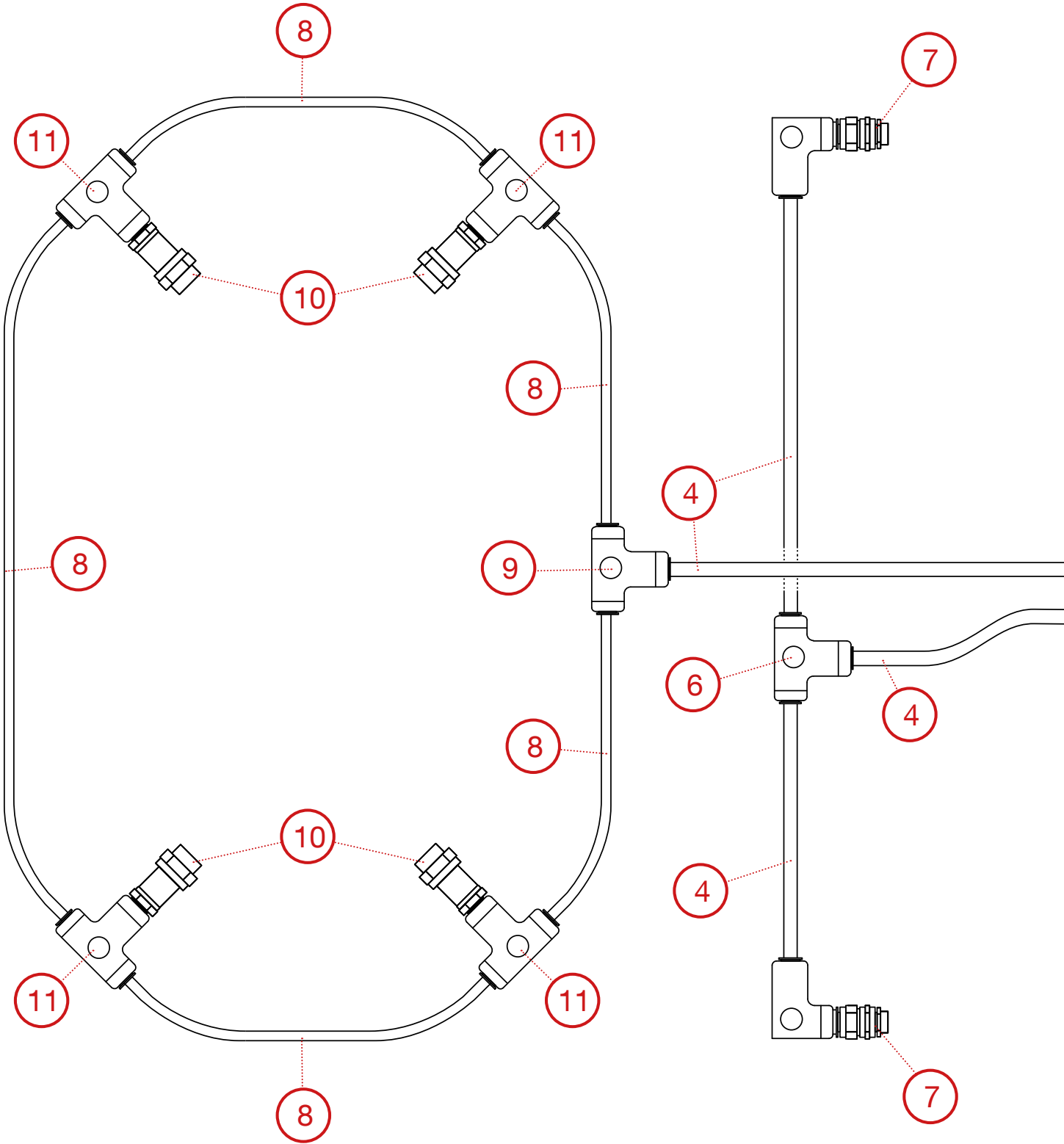

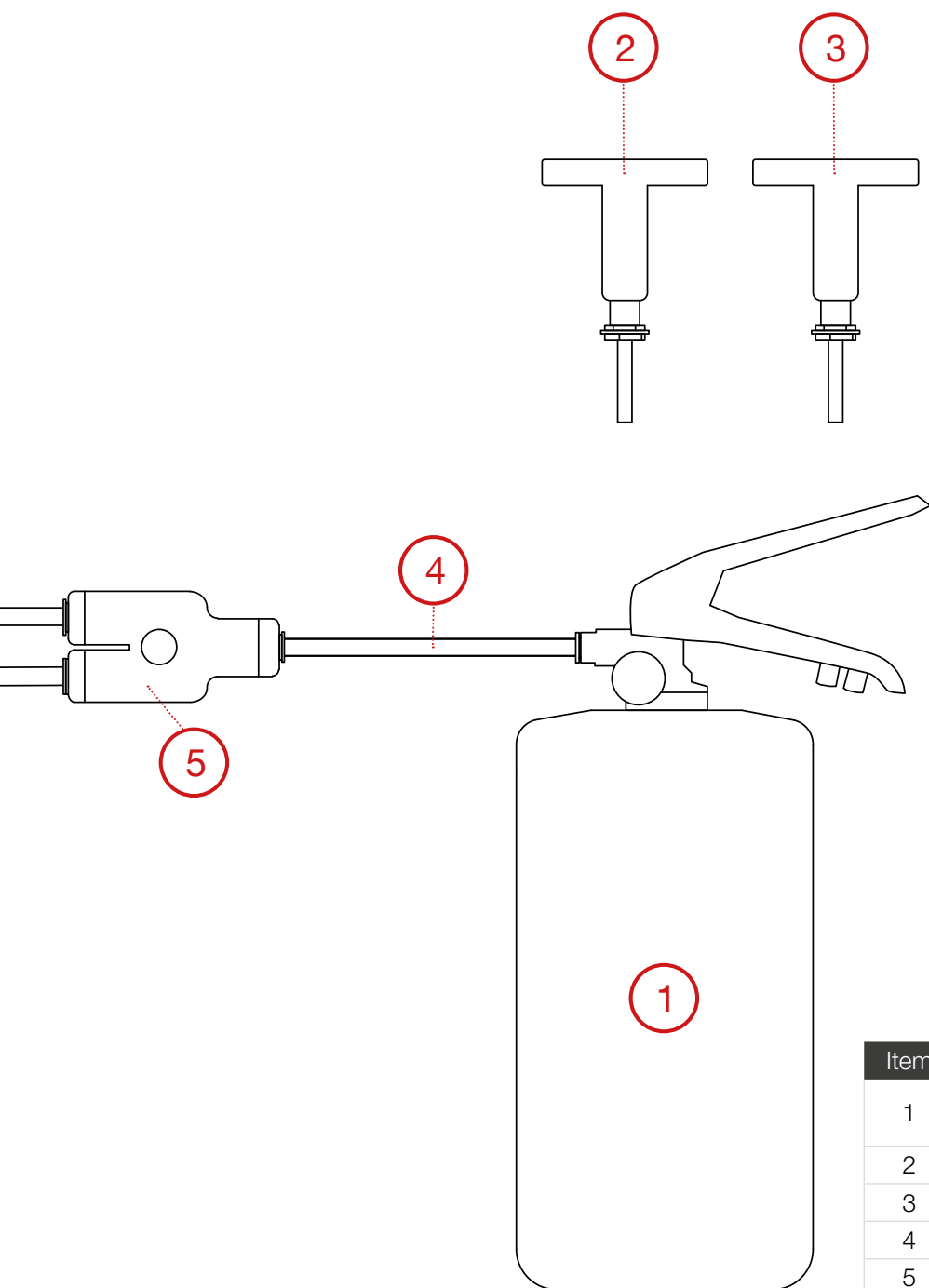

Item	Description
1	3.5ltr / 4.0ltr Mechanical Cylinder - Filled & Pressurised
2	6ft Pull Cable
3	12ft Pull Cable
4	10mm Aluminium Tubing
5	10mm Metal Y Connector
6	10mm Metal T Connector
7	Small Foam Cockpit Nozzle in Red Aluminium (with Elbow Connector)
8	8mm Aluminium Tubing
9	10mm to 8mm Swivel T Connector
10+11	Small Foam Engine Nozzle in Red Aluminium (with Swivel T Connector)

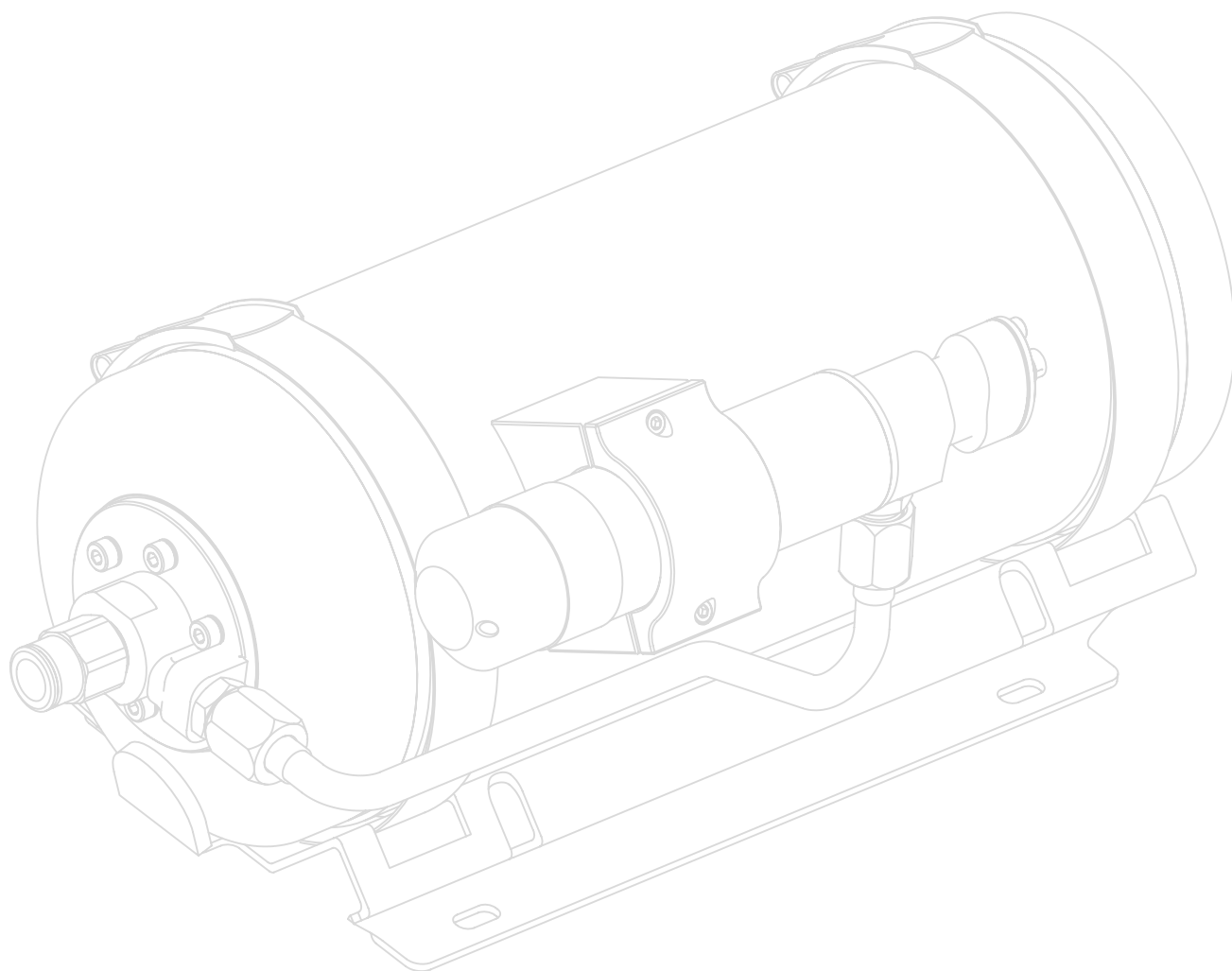

Fire Extinguisher Valve Company Ltd
Unit B3 Ford Airfield Industrial Estate
Ford, West Sussex. BN18 0HY

Tel: 01243 555566
Email: sales@f-e-v.co.uk

www.f-e-v.co.uk